

## CCI 50 / CCI 100 / CCI 200

CCI terminals are developed by the Competence Center ISOBUS e.V. and are used by several manufacturer of agriculture machines.

The CCI terminals have an App-like concept, where additional functionality can be licensed and enabled via "CCI.Apps".

CCI 50



CCI 100 / CCI 200



[sources: Competence Center ISOBUS e.V.]

## Disable / enable ISOBUS Task Controller (TC)

To run a NEVONEX Digital Service, NEVONEX must be the task controller (TC) and all other task controllers must be disabled. If it is not possible to disable a TC, the function instance of the TC must be increased. For more information on ISOBUS, see "Cheatsheet\_ISOBUS\_Info"

The ISOBUS TC can be disabled in the "App management".



- (1) Select "Settings" on the main screen

[picture sources: CCI 50 Operating instructions]



- (2) Activate "System settings" menu
- (3) Switch to the "App management" menu.

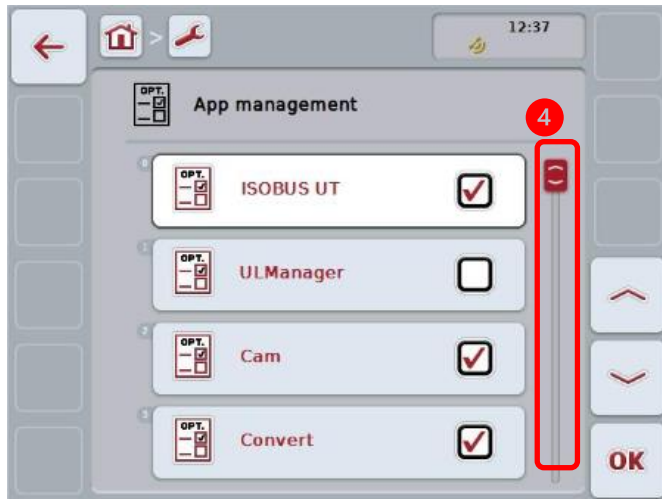

- (4) In the “App management”, scroll down to “CCI.Control” and when it is highlighted it can be disabled / enabled by pressing the selected entry.  
Do the same for “CCI.Command”.

Remark: After changing the settings, a restart of the terminal is required.

## Set function instance of Task Controller (TC)

To run a NEVONEX Digital Service, NEVONEX must be the task controller (TC) and all other task controllers must be disabled. If it is not possible to disable a TC, the function instance of the TC must be increased. For more information on ISOBUS, see “Cheatsheet\_ISOBUS\_Info”

The function instance (Task Controller No.) can be set in the “Advanced Settings” of the CCI.Control.

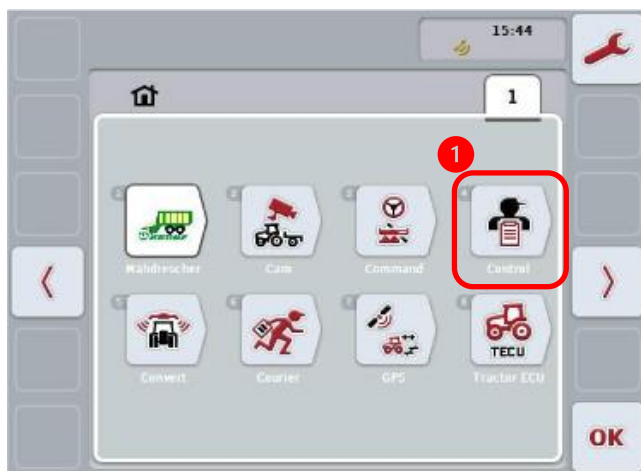

- (1) Select “Control” Setup-Menu” on the main screen.

[picture sources:  
CCI 50 Operating  
instructions

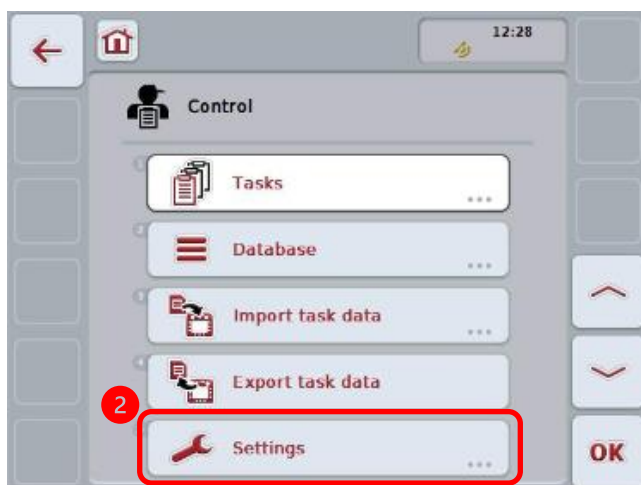

- (2) Select “Settings” on the Control menu



- (3) Select “Advances Settings” on the Settings menu

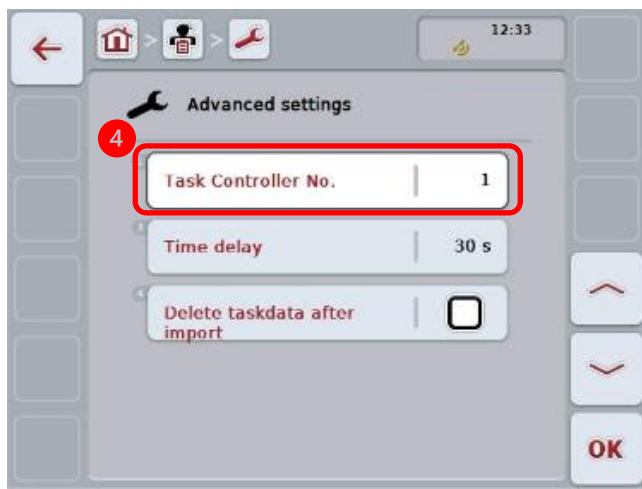

- (4) Set the desired “Task Controller No.”  
No 1 is function instance 0 on the ISOBUS and so one.

Remark: After changing the settings, a restart of the terminal is required